



## Stockleigh Road, St. Leonards-On-Sea TN38 0JP

Offers in excess of £150,000



Two bedroom GARDEN APARTMENT found right around the corner from central St. Leonards and just a short stroll to the beach. Enjoying a PRIVATE ENTRANCE this stylish property would make the perfect first time home or weekend retreat. The accommodation here boasts a BAY FRONTED LIVING ROOM, and separate kitchen and fitted bathroom. There are TWO DOUBLE BEDROOMS, the master room benefits from an EN-SUITE SHOWER ROOM. To the front of the property there is an ATTRACTIVE WALLED COURTYARD and a PRIVATE LAWNED GARDEN to the rear. This pad is being sold CHAIN FREE and with a lease term of approx. 57 years.

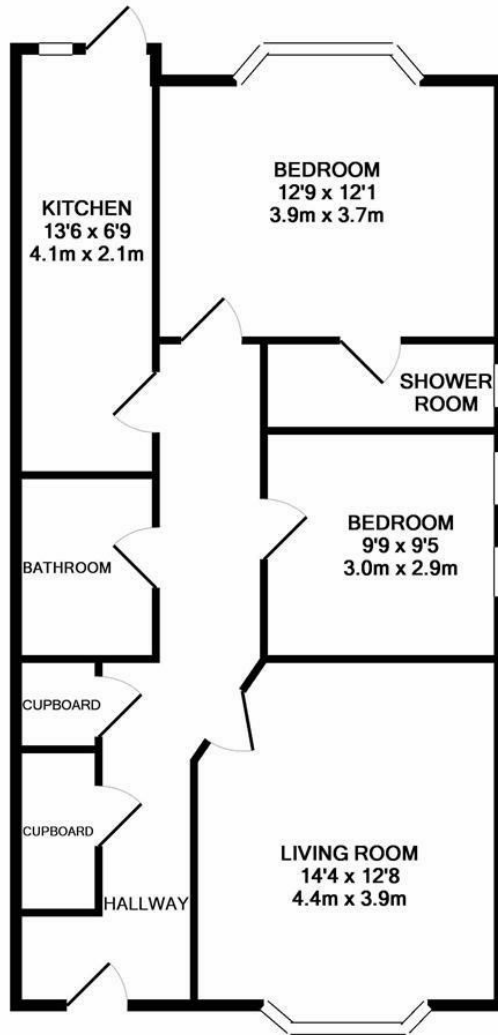

TOTAL APPROX. FLOOR AREA 787 SQ.FT. (73.1 SQ.M.)

Whilst every attempt has been made to ensure the accuracy of the floor plan contained here, measurements of doors, windows, rooms and any other items are approximate and no responsibility is taken for any error, omission, or mis-statement. This plan is for illustrative purposes only and should be used as such by any prospective purchaser. The services, systems and appliances shown have not been tested and no guarantee as to their operability or efficiency can be given  
 Made with Metropix ©2018

